

Picture 3

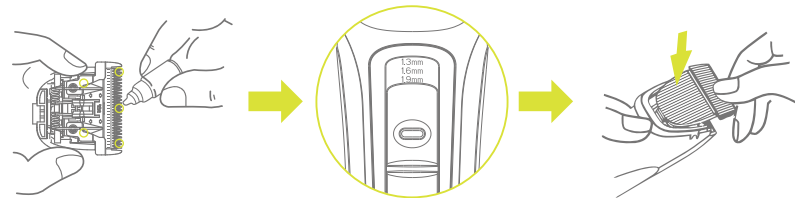

Picture 4

- ◆ Clean blades with small brush.
(Disassembling will cause malfunction. Do not attempt to disassemble.)



Picture 5

LEVER ADJUSTMENT

BLADE INSTALLATION

- ◆ After cleaning, apply tiny drop lubricant oil on the high light area of the blades, which shown on Picture 5
(Must hear a "click " sound and then into alignment with the slot in order to determine exactly loaded.

NOTE : Please put 1.9mm tip in position before loading.

12 MONTH LIMITED WARRANTY

JRL USA will repair or replace your unit (upon diagnosis of the defect) free of charge for 12 months from the date of purchase if the appliance has a manufacture's defect. To obtain service under the terms of the warranty, the defective unit must be returned to the JRL Service please email us info@jrlusa.com for return mailing address. Inside your package should be a copy of your sales receipt, a note which includes the defects of the unit and a check in the amount of \$15.00 to cover shipping & handling. Should there be a malfunction on the manufacture's behalf within the first 30 days of purchase, JRL will provide a call tag for the unit to be picked up free of charge. Once it is received, the replacement will be shipped. If the proof of purchase is not included with your defected item, the warranty will be voided.

ANY IMPLIED WARRANTIES, OBLIGATIONS, OR LIABILITIES, INCLUDING BUT NOT LIMITED TO THE IMPLIED WARRANTY OF MERCHANTABILITY AND FITNESS OR A PARTICULAR PURPOSE, SHALL BE LIMITED IN DURATION TO THE 12 MONTH DURATION OF THIS WRITTEN , LIMITED WARRANTY . Some states do not allow the exclusion or limitation of special, incidental, or consequential damages, so the above limitation may not apply to you.

IN NO EVENT SHALL JRL USA BE LIABLE FOR ANY SPECIAL, INCIDENTAL, OR CONSEQUENTIAL DAMAGES FRO BREACH OF THIS OR ANY OTHER WARRANTY, EXPRESSED OR IMPLIED, WHATSOEVER. Some states do not allow the exclusion or limitation of special, incidental, or consequential damages, so the above limitation may not apply to you.

This warranty gives the buyer specific legal rights. There may be other rights which vary from state to state.

Service Department
3850 S University Dr. #293152 Davie, FL 33329
Phone: +1 954-228-6666

Warranty Card

Customer contact information:

Client Name: _____ Contact Phone: _____

Address: _____

Date Purchased: _____ Exp of Warranty period: _____

Proof of purchase: Enclosed Not Enclosed (Warranty automatically voided)
(Note: Without warranty card, warranty will be subject to the time of manufactured)

Machine Serial Number: _____

Reason of Return: _____



JRL USA,LLC.
3850 S University Dr. #293152 Davie, LF 33329
www.jrlusa.com
Instagram : @jrlusa



FreshFade
THE PROFESSIONAL HAIR CLIPPER

Model: 1040

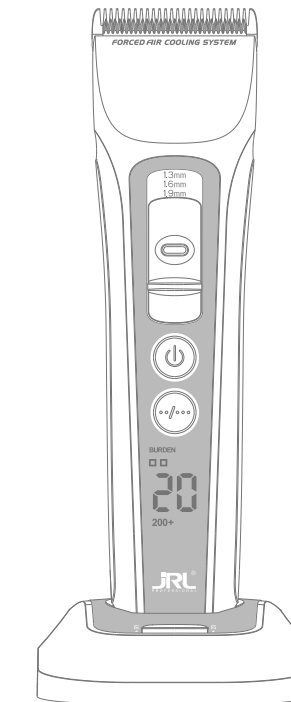

PATENTS:
201630368701.0
201520017469.6
201520017468.1
201520016129.1

Tips

- This product is designed for professional use only. This machine is not designed to be used on synthetic hair or for any other purpose other than cutting 100% human hair.
- The company will not take responsibility for malfunctions or damages caused by misuse.
- The safety instructions and the operating manual are also available in PDF format from our website: www.jrl.com.

Safety precautions

Keep Away from Children:

Please store clipper away from children.

Clipper contains sharp blades and small parts that can be harmful to minors.

Safety Use:

- This appliance can be used by children aged from 8 years and above and persons with reduced physical, sensory or mental capabilities or lack of experience and knowledge if they have been given supervision or instruction concerning use of the appliance in a safe way and understand the hazards involved.
- This appliance is not intended for use by persons (including children) with reduced physical, sensory or mental capabilities, or lack of experience and knowledge, unless they have been given supervision or instruction concerning use of the appliance by a person responsible for their safety.
- Children shall not play with the appliance.
- Cleaning and user maintenance shall not be made by children without supervision.
- The appliance is only to be used with the power supply unit provided with the appliance.
- WARNING: Keep the appliance dry.
- This appliance contains batteries that are non-replaceable.
- Unplug the power adapter before cleaning the clipper.
- Remove the blade first, then use cleaning brush to remove any hair buildup.
- Keep away from water in order to avoid shock or damage to the clipper.
- If the clipper is accidentally dropped into water or any other chemicals, discard immediately. Do not try to dry it and plug it into a power source.
- To properly store, remove clipper from dock, unplug adapter, and thoroughly clean your unit. Do not store the clipper on the charging dock or leave it attached to the adapter.
- If the cord on the power adapter is damaged, stop using it immediately and replace right away.
- Do not disassemble this product on your own. Visit authorized dealers for service and repair.
- Choose the correct voltage socket before charging (AC100-240V 50/60Hz).
- Please do not twist, disassemble or puncture the rechargeable battery within the clipper, otherwise it may cause a short circuit or burn the machine. If the battery is not working, do not run the clipper and take it to an authorized dealer.
- Extended use in temperatures below -10°C or above 40°C is not recommended as it may damage the battery.
- detachable power supply part (apply to KA1201A-0502000EU/KA1201A-0502000BS/KA1201A-0502000AU model adapter)
- Type of battery: Lithium ion battery
- Dispose of used batteries according to local regulations. Do not throw into household waste; use proper recycling or collection points.
- Avoid contact with leaking material. If contact occurs, rinse with water and seek medical advice. Use gloves and dispose of safety.
- Do not expose the appliance or battery to excessive temperatures
- Be aware of the risk of terminals of the battery-operated appliance or battery being short-circuited by metal objects.

To Avoid Product Damage:

- Only use original accessories.
- Do not sharpen the blade on your own.
- WARNING: For the purposes of recharging the battery, only use the detachable supply unit provided with this appliance.

Product Overview

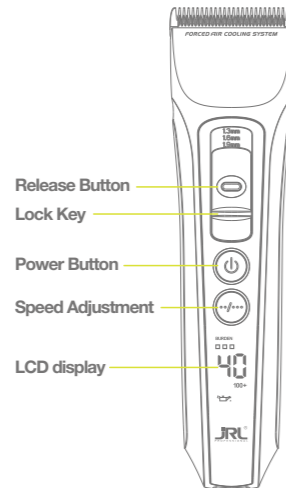

Professional Clipper X1



Brush X1



Lubricant X1



3-6mm Guard X1

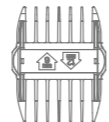

9-12mm Guard X1

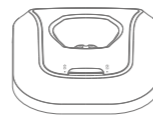

Charging Base X1

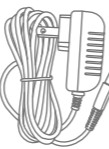

Adapter X1

Product Specifications

Model: 1040			
Item	Specifications	Item	Specifications
Adapter	Input AC100V-240V 50-60Hz	Charge Type	Lithium-ion battery
	Output DC3.5V 1000mA	Charging Time	About 3 hours
Rechargeable Battery	3.7V 2600mAh	Fully Charged Operable	About 5 hours

Screen Display

The LCD screen displays the features and control functions listed below:

Smart Clip Sensor

Senses blade resistance and revs up the motor speed

Motor Speed (Rotation per minute)

Model 1040 with either the cord or the battery has 5 speed settings ranging from 5,000 RPM to 7,500 RPM.

Level of blade load

Shows levels of blade resistance from weakest "□" to strongest "□□□□□".

Remaining Time

Displays time left to use clipper before clipper dies and display time when fully charged.

Charging Tips

When the unit has about 10 min left of power, the clipper will remind you to charge by making 3 ticking sounds.

Lubing

The oil indicator will blink indicating that the unit needs to be oiled after 60 min of appearing on the screen.

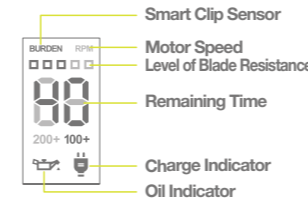

Charging Functions

Not only can the users charge the unit from the portable charging base, the user can also charge the clipper by directly plugging in the power cord to the clipper itself.

Fast Charging Method

Connect charging base to the power adapter, blue light turns on. The set mode rapid Fast Charging Method "⚡" takes approximately three hours.

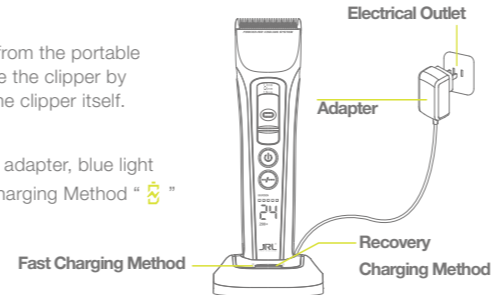

Recovery Charging Method

Press the button once on charging base to switch to recovery charge "⚡". Using the recovery charging method will extend the life of battery and take about 6 hours to fully charge. A green light will appear when charging. When the recovery charge function is not in use, a white light will appear and will charge the unit in less.

When clipper is charging, the blade resistance indicator will flash ("□□□□□" 5 times) and the charge indicator light "⚡" will remain on. When the clipper is fully charged, the blade resistance indicator will stop flashing. And the charge indicator light will disappear. There will be a beeping sound to remind the user that the battery is fully charged and clipper can be removed from the charging base.

Operations

Power Button

Tap the power switch button (shown at right) to match to turn the clipper on. Tap it again to shut off.

Speed Button

Adjust the speed button (shown at right) to pick the level of speed desired. There are 5 options of speed available. Each will make a "drop" tone sound when the gear is selected.

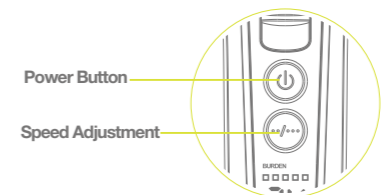

Length Adjustments

The clipper has four adjustments (1.0mm \ 1.3mm \ 1.6mm \ 1.9mm)
The user is able to adjust accordingly

- When moving upwards for a shorter hair length, use your thumb to push the "Lock Key" directly to the corresponding adjustment.
- When moving downwards for longer hair length, press the "Release Button" using your thumb to push down to the corresponding adjustment.

NOTE: When moving upwards, please do not press the Release Button, in order to avoid the lever can not lock.

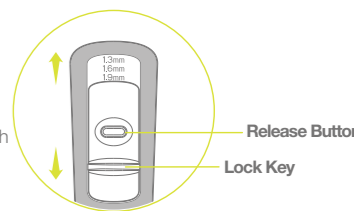

Function and handling methods with guard

The guards are used to determine how much of the hair will be trimmed off. The sizes included are 3mm, 6mm, 9mm, 12mm.

Guard Installation:

Fasten guard by sliding the guard in a downward position then forward position. When lodged, guard will not fall off during use.)

Remove guard method:

Remove the guard by pulling the guard towards yourself and then in an upward position.

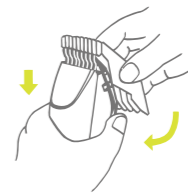

Cleaning and removing blade set

To remove blade set, first make sure your clipper motor is switched 'OFF', then push down with one or both thumbs (Picture 1) and slide blade off blade hinge (Picture 2).

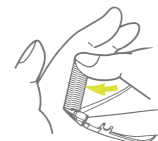

Picture 1



Picture 2