

## Tips

1. This product is designed for professional use only. This machine is not designed to be used on synthetic hair or for any other purpose other than cutting 100% human hair.
2. The company will not take responsibility for malfunctions or damages caused by misuse.
3. The safety instructions and the operating manual are also available in PDF format from our website: [www.jrl.com](http://www.jrl.com).

## Safety precautions

### Keep Away from Children:

Please store clipper away from children.

Clipper contains sharp blades and small parts that can be harmful to minors.

### Safety Use:

1. This appliance can be used by children aged from 8 years and above and persons with reduced physical, sensory or mental capabilities or lack of experience and knowledge if they have been given supervision or instruction concerning use of the appliance in a safe way and understand the hazards involved.
2. This appliance is not intended for use by persons (including children) with reduced physical, sensory or mental capabilities, or lack of experience and knowledge, unless they have been given supervision or instruction concerning use of the appliance by a person responsible for their safety.
3. Children shall not play with the appliance.
4. Cleaning and user maintenance shall not be made by children without supervision.
5. The appliance is only to be used with the power supply unit provided with the appliance.
6. WARNING: Keep the appliance dry.
7. This appliance contains batteries that are non-replaceable.
8. Unplug the power adaptor before cleaning the clipper.
9. Remove the blade first, then use cleaning brush to remove any hair buildup.
10. Keep away from water in order to avoid shock or damage to the clipper.
11. If the clipper is accidentally dropped into water or any other chemicals, discard immediately. Do not try to dry it and plug it into a power source.
12. To properly store, remove clipper from dock, unplug adapter, and thoroughly clean your unit. Do not store the clipper on the charging dock or leave it attached to the adapter.
13. If the cord on the power adapter is damaged, stop using it immediately and replace right away.
14. Do not disassemble this product on your own. Visit authorized dealers for service and repair.
15. Choose the correct voltage socket before charging (AC100-240V 50/60Hz).
16. Please do not twist, disassemble or puncture the rechargeable battery within the clipper, otherwise it may cause a short circuit or burn the machine. If the battery is not working, do not run the clipper and take it to an authorized dealer.
17. Extended use in temperatures below -10°C or above 40°C is not recommended as it may damage the battery.
18.  detachable power supply part (apply to KAI201A-0502000EU/KAI201A-0502000BS/KAI201A-0502000AU model adapter)
19. Type of battery: Lithium ion battery
20. Dispose of used batteries according to local regulations. Do not throw into household waste; use proper recycling or collection points.
21. Avoid contact with leaking material. If contact occurs, rinse with water and seek medical advice. Use gloves and dispose of safely.
22. Do not expose the appliance or battery to excessive temperatures
23. Be aware of the risk of terminals of the battery-operated appliance or battery being short-circuited by metal objects.

### To Avoid Product Damage:

1. Only use original accessories.
2. Do not sharpen the blade on your own.
3. WARNING: For the purposes of recharging the battery, only use the detachable supply unit provided with this appliance.

**JRL**  
PROFESSIONAL

JRL USA, LLC.  
3850 S University Dr.  
#293152  
Davie, FL 33328 USA



[www.jrl.com](http://www.jrl.com)



@jrlusa  
@jrlprofessional



PVC



PE-LD



PAP



Manufacturer: Guang Zhou Eagle Fortress Hair Products Ltd.  
Address: No.4 Shuanglong Yucai Street, Shiling Town, Huadu District,  
Guangzhou, 510899, China

European Authorised Representative (AR) Name : Chemical Inspection & Regulation Service Limited  
AR Address : CIRIS, Regus Harcourt Centre, Dublin, Ireland, D02 HW77  
AR Mail : [service@ciris-group.com](mailto:service@ciris-group.com)

PATENTS:  
201730544284.5  
201520017469.6

**FRESHFADE**  
Professional Cordless Hair Clipper  
FreshFade 1090

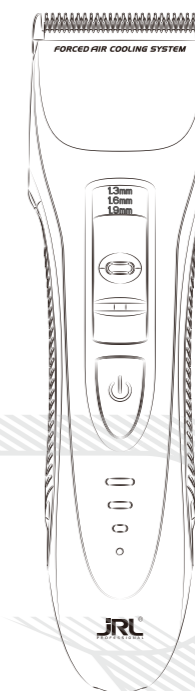

USER'S MANUAL

## Product overview

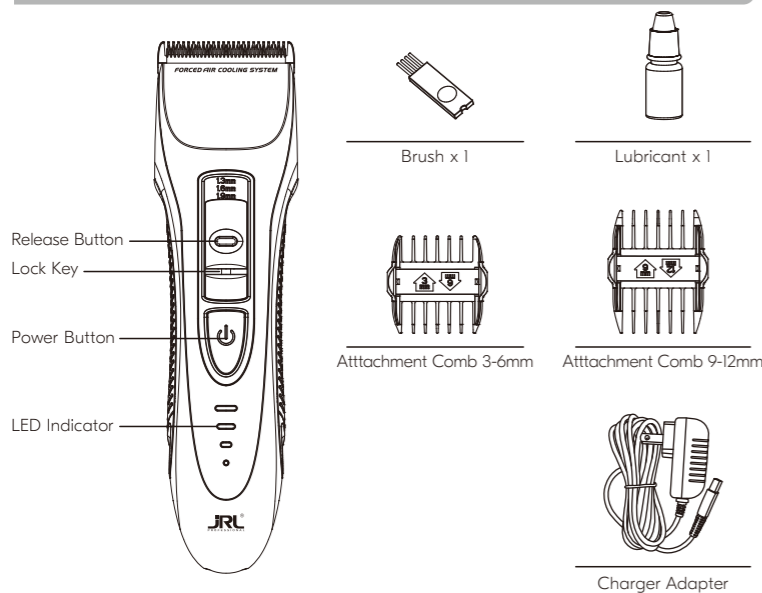

## Product specifications

Product code: 1090			
Item	Specifications	Item	Specifications
Power adapter	Input AC100-240V 50/60Hz	Type of battery	Lithium ion battery
	Output DC5V 1A	Charging time	4 hours
Battery capacity	3.7V 3200mAh	Usage time	7 hours

## How to charge your clipper

As shown on the right, the power cord can be connected directly to the clipper to charge.

 **Note:** When the clipper is low on charge, the adapter can be plugged onto the clipper directly. You may use the clipper while it is charging.

**Important: Use only original power cord to charge.**

### LED functions

- When the clipper is charging, the charging indicator light flashes. Once fully charged, the full battery indicator light will remain on, and all other indicator lights will turn off.
- When the clipper battery is low, the low battery indicator light will flash.
- When the clipper has less than 10 minutes of usable time, the charging indicator light will flash as a reminder to recharge the unit.

## How to operate

### Switching and shifting instructions

Press the power button to power the clipper on and off.

### Clipper status indication by LED light

LED indicators show four different functions:

- Indicates the state of the product being charged.
- Indicates battery remaining power status.
- Indicates when unit needs to be oiled.
- After 60 mins of using the clipper or if the motor feels like it has stalled, the oil lamp indicator will blink a few times as a reminder that the unit needs to be cleaned and oiled.

## Adjusting the cutting length

**NOTE:** Do not press the release button when moving upwards. Doing so may cause the lever to become loose and unable to lock into place.

The clipper comes with 4 different adjustment levels, which are: 1.0mm, 1.3mm, 1.6mm, 1.9mm.

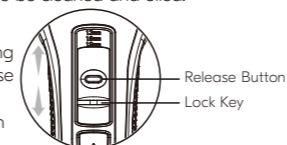
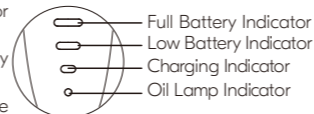
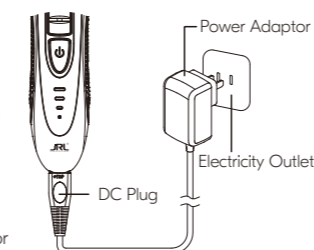

Users can adjust the level according to their needs.

- Push the 'Lock Key' upward for a shorter cut.
- Push the 'Lock Key' back for longer cut.

## How to install the guards

Clipper comes with 2 guards including 4 sizes.

### Installing your guard

As shown on the right, Fasten guard by sliding the guard in a downward position then forward position. When lodged, guard will not fall off during use.

### Removing your guard

As shown on the right, Remove the guard by pulling the guard towards your self and then in an upward position.

## Blade cleaning and maintenance

**NOTE: Please put 1.9mm tip in position before loading.**

To remove blade set, first make sure your clipper motor is switched "OFF", then push down with one or both thumbs ( Figure 1) and slide blade off blade hinge ( Figure 2).

- Clean blades with small brush. (Disassembling will cause malfunction. Do not attempt to disassemble.)

- After cleaning, apply tiny drop lubricant oil on the high light area of the blades, which shown on Figure 4 ( Must hear a "click " sound and then into alignment with the slot in order to determine exactly loaded.

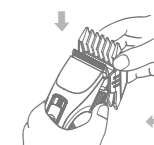

Figure 1



Figure 2

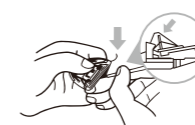

Figure 3

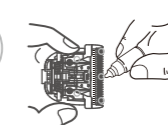
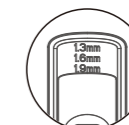
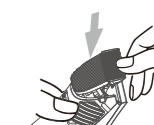

Figure 4



Lever Adjustment



Blade Installation